

PRO X

Wall-hung WC compact, Silent flush, washdown, EasyFit 3.0 fixation



DIMENSIONS

Length	490 mm
Width	360 mm
Height	345 mm

COLOURS AND FINISHES

000 White

#mountingAccessoriesExcluded_text

Stone screw fastening kit M12

Commodity Code/Import Code Number for Foreign Trad : 69109000

Fixing kit : EasyFit 3.0 included

Flushing system : Washdown

Installation type : Wall-hung

Net weight (kg) : 23.2

Outlet type : Horizontal

Rim type : Rimless Silent Flush

Shape : Round

TECHNICAL DRAWINGS

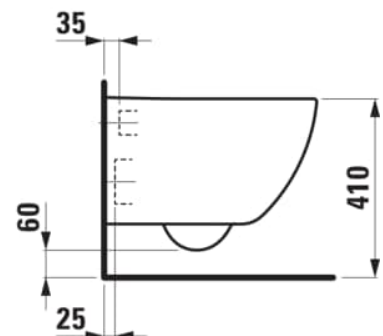
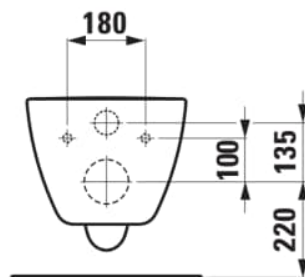
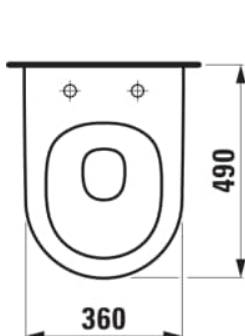

COMPATIBLE WITH

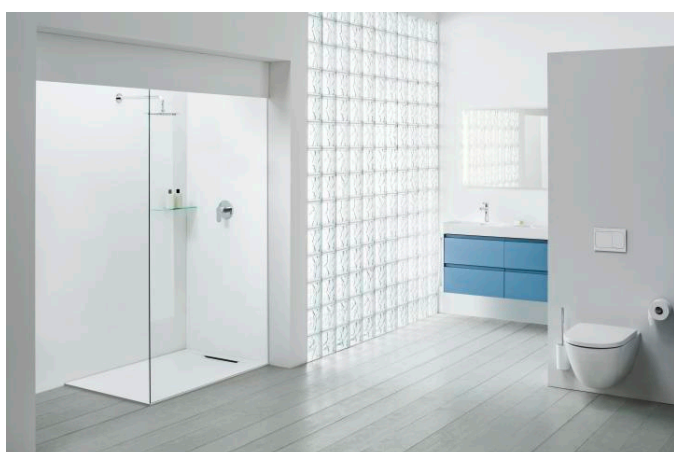
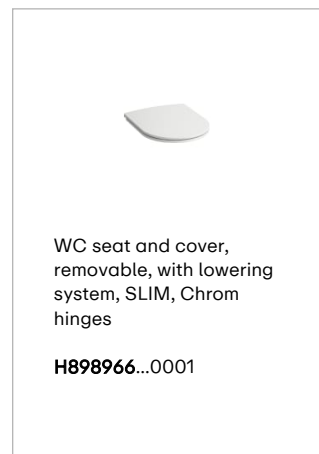
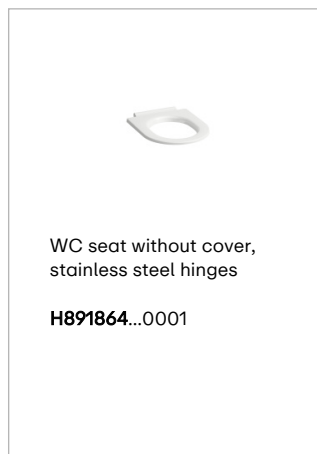
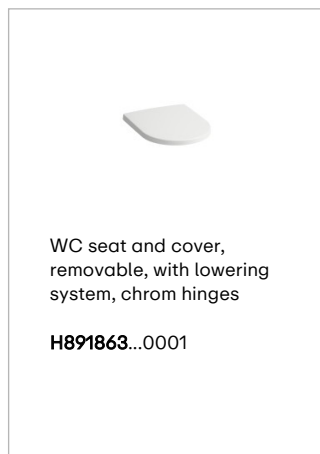
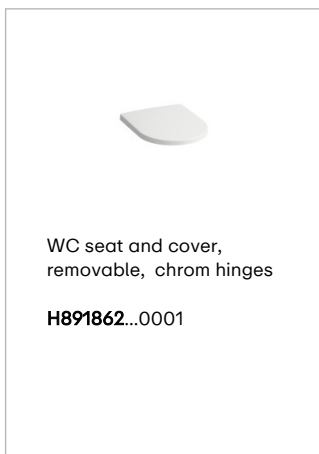









PRO X

Marking the third generation of this highly successful collection, PRO X integrates timeless aesthetics with cutting-edge technology to deliver maximum investment security.

Designed to meet the needs of private homes, hospitality projects, and public spaces, it offers a versatile and contemporary solution for modern bathrooms.

